

# SPIRAL MITER GEARS

**18 THROUGH 5 DIAMETRAL PITCH**  
**STEEL—UNHARDENED AND HARDENED**

**1:1 RATIO 20° PRESSURE ANGLE**  
**35° SPIRAL ANGLE**

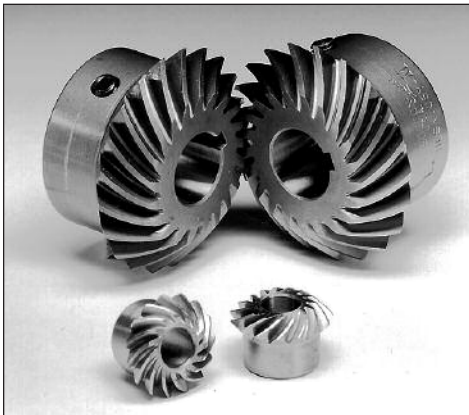

All hardened steel gears have teeth only hardened, except as noted, and are equipped with standard keyways and setscrews

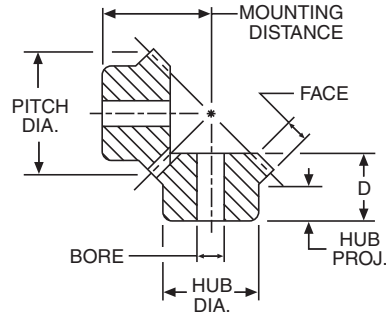

## REFERENCE PAGES

- Alterations — 149
- Horsepower Ratings — 71
- Lubrication — 149
- Materials — 150
- Selection Procedure — 67

## STANDARD TOLERANCES

| DIMENSION |     | TOLERANCE |
|-----------|-----|-----------|
| BORE      | All | ±.0005    |

ALL DIMENSIONS IN INCHES  
 ORDER BY CATALOG NUMBER OR ITEM CODE

| No. of Teeth              | Pitch Dia. | Face | Bore   | MD *  | D     | Hub                     |       | Catalog Number           | Item Code             | Catalog Number             | Item Code      |
|---------------------------|------------|------|--------|-------|-------|-------------------------|-------|--------------------------|-----------------------|----------------------------|----------------|
|                           |            |      |        |       |       | Dia.                    | Proj. |                          |                       |                            |                |
| <b>18 DIAMETRAL PITCH</b> |            |      |        |       |       |                         |       |                          |                       |                            |                |
|                           |            |      |        |       |       | <b>STEEL UNHARDENED</b> |       |                          | <b>STEEL HARDENED</b> |                            |                |
| 18                        | 1.000      | .22  | .375   | 1.062 | .739  | .75                     | .44   | LSA110Y-R<br>LSA110Y-L   | 12310<br>12312        | HLSK110Y-R†<br>HLSK110Y-L† | 12322<br>12324 |
| <b>12 DIAMETRAL PITCH</b> |            |      |        |       |       |                         |       |                          |                       |                            |                |
| 15                        | 1.250      | .30  | .500   | 1.250 | .864  | 1.00                    | .50   | LSA101Y-R<br>LSA101Y-L   | 12282<br>12284        | HLSK101Y-R†<br>HLSK101Y-L† | 12336<br>12338 |
| 18                        | 1.500      | .34  | .625   | 1.500 | 1.021 | 1.25                    | .56   | LSA102Y-R<br>LSA102Y-L   | 12286<br>12288        | HLSK102Y-R<br>HLSK102Y-L   | 12340<br>12342 |
| <b>10 DIAMETRAL PITCH</b> |            |      |        |       |       |                         |       |                          |                       |                            |                |
| 20                        | 2.000      | .47  | .750   | 2.000 | 1.364 | 1.62                    | .78   | LSA103Y-R<br>LSA103Y-L   | 12290<br>12292        | HLSK103Y-R<br>HLSK103Y-L   | 12354<br>12356 |
| 25                        | 2.500      | .58  | .875   | 2.438 | 1.630 | 2.00                    | .91   | LSA104Y-R<br>LSA104Y-L   | 12294<br>12296        | HLSK104Y-R<br>HLSK104Y-L   | 12358<br>12360 |
| <b>8 DIAMETRAL PITCH</b>  |            |      |        |       |       |                         |       |                          |                       |                            |                |
| 28                        | 3.500      | .78  | 1.1875 | 3.250 | 2.099 | 2.50                    | 1.25  | LSA106Y-R<br>LSA106Y-L   | 12302<br>12304        | HLSK106Y-R<br>HLSK106Y-L   | 12376<br>12378 |
| <b>7 DIAMETRAL PITCH</b>  |            |      |        |       |       |                         |       |                          |                       |                            |                |
| 21                        | 3.000      | .69  | 1.000  | 2.750 | 1.786 | 2.50                    | .88   | LSA105YA-R<br>LSA105YA-L | 12298<br>12300        | HLSK105YA-R<br>HLSK105YA-L | 12380<br>12382 |
| <b>6 DIAMETRAL PITCH</b>  |            |      |        |       |       |                         |       |                          |                       |                            |                |
| 24                        | 4.000      | .89  | 1.250  | 3.625 | 2.317 | 3.00                    | 1.31  | LSA118Y-R<br>LSA118Y-L   | 12314<br>12316        | HLSK118Y-R<br>HLSK118Y-L   | 12392<br>12394 |
|                           |            |      | 1.500  |       |       |                         |       | LSA107Y-R<br>LSA107Y-L   | 12306<br>12308        | HLSK107Y-R<br>HLSK107Y-L   | 12388<br>12390 |
| <b>5 DIAMETRAL PITCH</b>  |            |      |        |       |       |                         |       |                          |                       |                            |                |
| 25                        | 5.000      | 1.15 | 1.375  | 4.625 | 3.005 | 3.50                    | 1.75  | LSA122Y-R<br>LSA122Y-L   | 12318<br>12320        | HLSK122Y-R<br>HLSK122Y-L   | 12400<br>12402 |

\*Mounting Distance (MD) must not be made less than dimension shown, see Page 144.

†Hardened all over.